

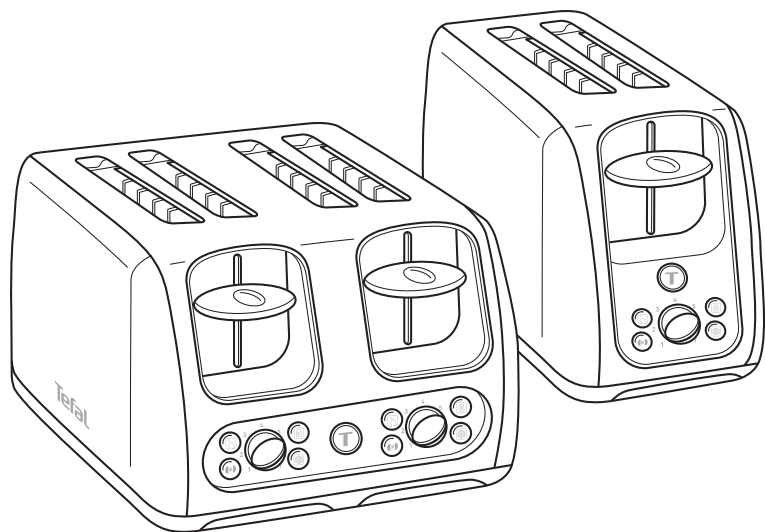



Tefal



www.tefal.com

SAFETY INSTRUCTIONS

IMPORTANT SAFEGUARDS:

- This appliance is not intended to be operated using an external timer or separate remote control system.
-  **For your safety, this appliance conforms with applicable standards and regulations (Directives on low voltage, electromagnetic compatibility, materials in contact with foodstuffs, environment, etc.)**
-  **In accordance with the CSC notice of 2/12/04, this product features a mechanical design allowing the bread ejection mechanism to be detached from the power cut-off element.**
- Check that the electricity supply voltage corresponds to the voltage indicated on the appliance (ac current only).
- Given the many standards in effect, if this toaster is used in a country other than the country where it was purchased, have it checked by an approved service centre (see enclosed after sales service information).
- Check that the electricity installation is sufficient to supply the power required by this appliance.
- Always plug the toaster into an earthed socket.
- Use extension leads which are in good condition, with an earthed connection, and with a minimum rating of 10A.
-  **This appliance is intended to be used in household only.**
Any commercial use, inappropriate use or failure to comply with the instructions, the manufacturer accepts no responsibility and the guarantee will not apply.
It is not intended to be used in following applications, and the guarantee will not apply for:
 - staff kitchen areas in shops, offices and other working environments;
 - farm houses;
 - by clients in hotels, motels and other residential type environments;
 - bed and breakfast type environments.



TO PREVENT ANY ACCIDENTS

When using electrical appliances, basic safety precautions should always be followed:

DO:

- Carefully read and follow all the instructions for use.
- The toaster must always be used in the upright position, never on its side or tilted forwards or backwards.
-  **Before each use make sure that the crumb tray is fitted correctly.**
- Regularly remove crumbs from the crumb tray.
- The bread control lever must be in the "Up" position before plugging in or unplugging the appliance.
- Unplug the appliance if it shows any working abnormalities.
- Unplug from the power socket when not in use during and before cleaning. Allow to cool down before cleaning or storing.
- To unplug remove the plug from the wall socket (when the toasting cycle is finished).
- If the bread jams in the slots after toasting and the elements do not switch off, unplug the plug immediately and wait for the appliance to cool before attempting to remove the bread.
- Bread can burn; Therefore do not use this appliance near any flammable materials such as curtains, under shelving or under wall cupboards.
- Use on a flat, stable heat-resistant work surface, away from any contact with water and never use underneath a built in kitchen alcove.

DO NOT:

- Do not let the toaster operate unattended, particularly when toasting for the first time or when settings have been changed.
- Do not store the cord or the plug between the slots in the appliance.
- Do not unplug the appliance by pulling on the cord.
- Do not move or carry the appliance during use.
-  **This appliance is not intended for use by persons (including children) with reduced physical, sensory or mental capabilities, or lack of experience and knowledge, unless they have been given supervision or instruction concerning use of the appliance by a person responsible for their safety.**
-  **Children must be supervised to ensure**

that they do not play with the appliance.

- Do not leave the appliance within the reach of children.
- Do not use outdoors. Avoid humid environments.
- Do not use the appliance for any other use other than that for which it was designed.
- Do not touch the metal parts or hot surfaces of the appliance when it is working.

- Oversized foods, metal foil packages, or utensils (spoon, knife, etc.) must not be inserted into a toaster as they may cause an electric shock or fire.
- Do not use accessory attachments that are not recommended by the manufacturer as this may be dangerous.
- To protect yourself against an electrical shock do not immerse the cord, plugs, or appliance in water or other liquids.

 **Do not place any sugar coated type of bread in the toaster or anything that may melt or drop into the toaster, do not toast small pieces of bread or croutons as this may cause damage to the toaster or a risk a fire.**

 **Do not try to toast very thick slices of bread that could become stuck in the toasting slots.**

- Do not use this appliance if:
 - it has a damaged cord.
 - the appliance has been dropped or has visible damage or does not operate properly.

In any of these instances, the appliance must be sent to your local approved after-sales service centre to avoid any risk of danger. Refer to the guarantee enclosed.

- If the supply cord is damaged, it must be replaced by the manufacturer, its service agent or similarly qualified persons in order to avoid a hazard.
- Do not let the cord hang over the edge of the worktop or come into contact with hot surfaces.
- Do not place on or near a gas burner, electric ring/hob, or near a heated oven.
- Do not cover this appliance while in use.

 **Bread can burn, therefore the appliance must not be used near or below curtains and other combustible materials such as curtains, drapes or wood (shelving,**

cupboards...) it should be attended when in use.

- Do not put paper towels, cardboard or plastic in, on or under the toaster.
-  **If flames were to arise from parts of the toaster, never attempt to extinguish them with water. Unplug the appliance and smother the flames with a damp cloth.**
- Do not attempt to dislodge food once the toasting cycle is engaged.
- Do not use this appliance as a source of heating or drying.
- Do not use the toaster for cooking, grilling or defrosting frozen food other than bread products.
- Do not use the appliance to toast bread and warm croissants (or similar products) at the same time (depending on model).
- The metal frame can become very hot. Do not touch it! Use an oven glove or tongs (depending on model).
- Do not use any abrasive cleaning agents (no soda-based scouring products, no scouring pads...), no metallic utensils, metal scouring pads etc.
- For appliances with a metallic finish: Do not use any cleaning products designed for metals: use a soft cloth with a window or glass cleaner.

SAVE THESE INSTRUCTIONS



Environment protection first !

- ① Your appliance contains valuable materials which can be recovered or recycled.
- ➡ Leave it at a local civic waste collection point.

If you have any product problems or queries please contact our Helpline:

0845 602 1454 - UK

(01) 677 4003 - ROI

or consult our website: www.tefal.co.uk

1. FIRST USE

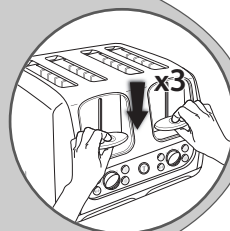
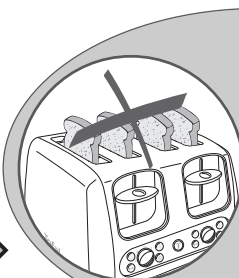
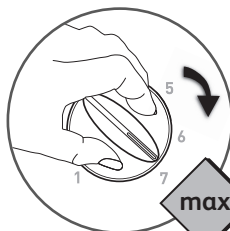
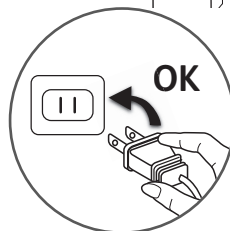
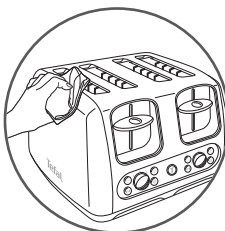
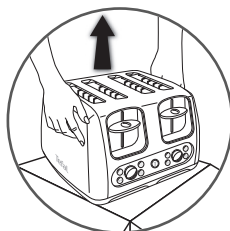
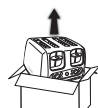

2. TOASTING

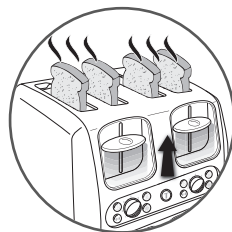
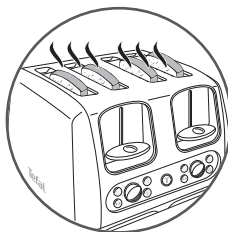
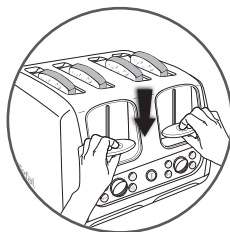
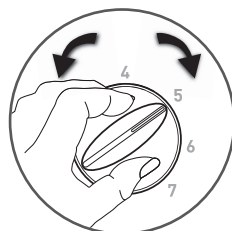
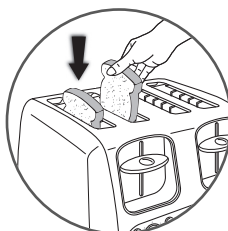
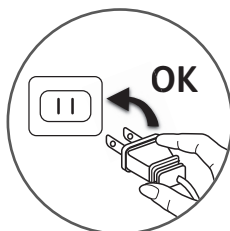

3. HIGH-LIFT

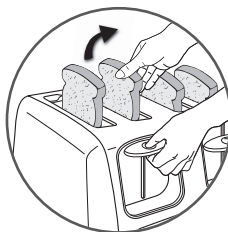
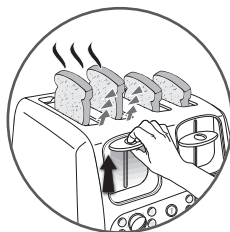
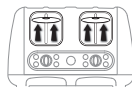

4. STOP/EJECT

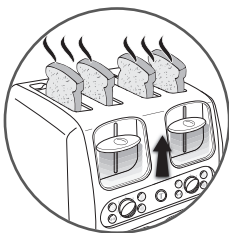
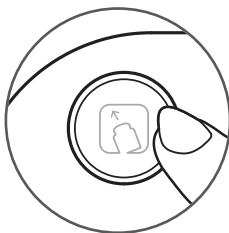

5. REHEAT

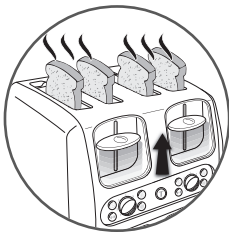
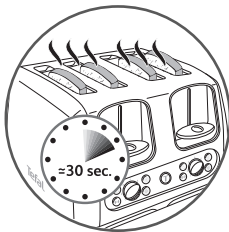
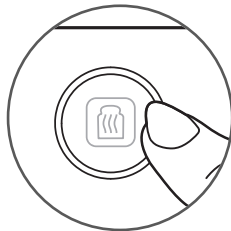
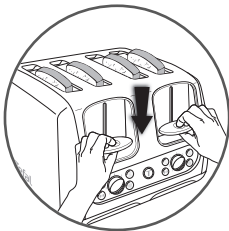
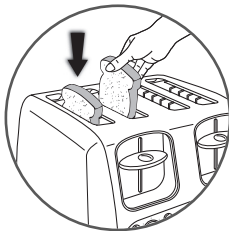

6. DEFROST

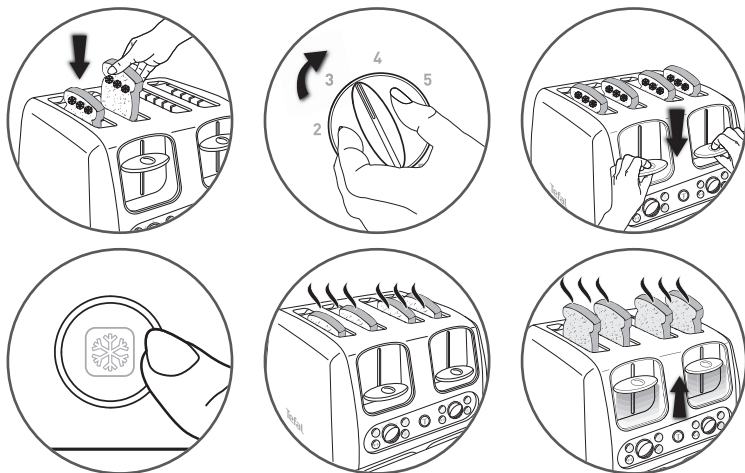

7. MUFFIN / BAGEL

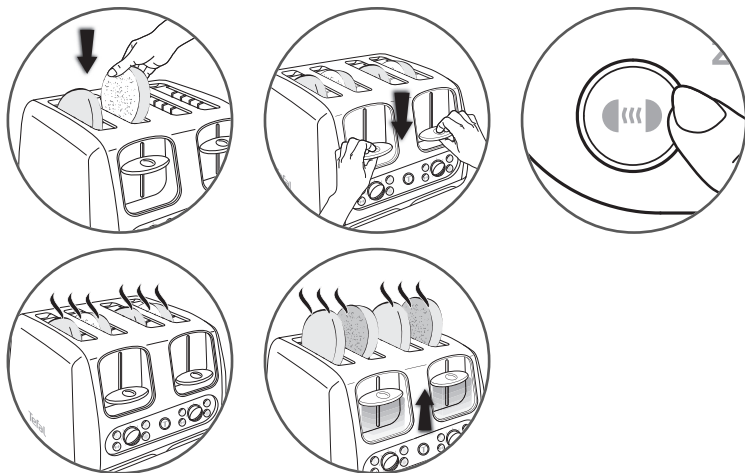

8. CLEANING

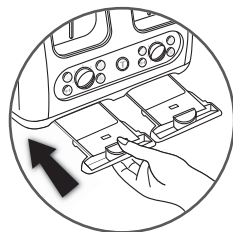
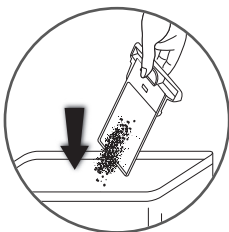
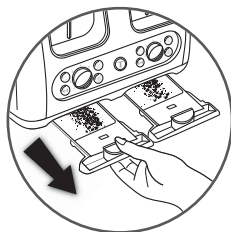
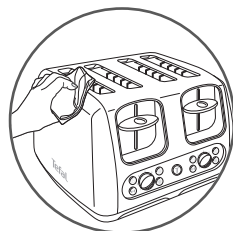
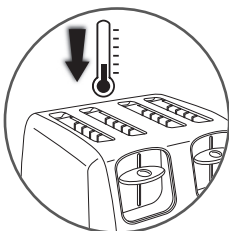
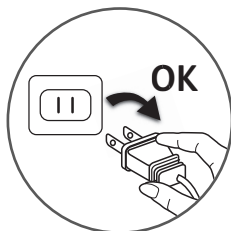

9. DO NOT

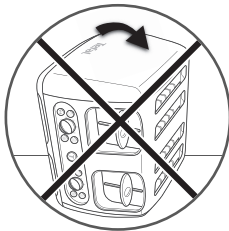
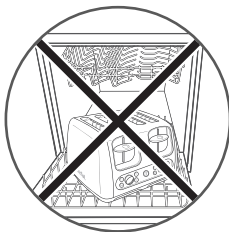

 : www.tefal.co.uk			
			
UNITED KINGDOM	GRUPE SEB UK Ltd. 11-49 Station Road Langley, Slough Berkshire SL3 8 DR	0845 602 1454	1 year
REPUBLIC OF IRELAND	GRUPE SEB IRELAND Unit B3 Aerodrome Business Park, College Road, Rathcoole, Co. Dublin	01 677 4003	1 year

TEFAL / T-FAL INTERNATIONAL GUARANTEE

Date of purchase:

Product reference:

Retailer name & address:

Distributor stamp

TEFAL / T-FAL* INTERNATIONAL LIMITED GUARANTEE



: www.tefal.com / www.t-fal.com

*This product is **repairable** by TEFAL / T-FAL, during and after the **guarantee** period.*

The Guarantee

This product is guaranteed by TEFAL / T-FAL (company address and details included in the country list of the TEFAL/T-FAL International Guarantee) against any manufacturing defect in materials or workmanship during the guarantee period within those countries as stated in the country list on the last page of the user manual, starting from the initial date of purchase. The international manufacturer's guarantee by TEFAL/T-FAL is an extra benefit which does not affect consumer's Statutory Rights.

The international manufacturer's guarantee covers all costs related to restoring the proven defective product so that it conforms to its original specifications, through the repair or replacement of any defective part and the necessary labour. At TEFAL/T-FAL's choice, a replacement product may be provided instead of repairing a defective product. TEFAL/ T-FAL's sole obligation and your exclusive resolution under this guarantee are limited to such repair or replacement.

Conditions & Exclusions

The international TEFAL/T-FAL guarantee only applies within the guarantee period and for those countries listed in the Country List attached and is valid only on presentation of a proof of purchase. The product can be taken directly in person to an authorised service centre or must be adequately packaged and returned, by recorded delivery (or equivalent method of postage), to a TEFAL/T-FAL authorised service centre. Full address details for each country's authorised service centers are listed on TEFAL/T-FAL website (www.tefal.com / www.t-fal.com) or by calling the appropriate telephone number as set out in the Country List to request the appropriate postal address.

TEFAL/T-FAL shall not be obliged to repair or replace any product which is not accompanied by a valid proof of purchase.

This guarantee will not cover any damage which could occur as a result of misuse, negligence, failure to follow TEFAL/T-FAL instructions, use on current or voltage other than as stamped on the product, or a modification or unauthorised repair of the product. It also does not cover normal wear and tear, maintenance or replacement of consumable parts, or the following:

- using the wrong type of water or consumable
- scaling (any de-scaling must be carried out according to the instructions for use);
- ingress of water, dust or insects into the product;
- mechanical damages, overloading
- damages or bad results due to wrong voltage or frequency
- accidents including fire, flood, thunderbolt etc
- professional or commercial use
- damage to any glass or porcelain ware in the product
- replacement of consumables

This guarantee does not apply to any product that has been tampered with, or to damages incurred through improper use and care, faulty packaging by the owner or mishandling by any carrier.

The international TEFAL/T-FAL guarantee applies only for products purchased in one of the countries listed, and used for domestic purposes only in one of the countries listed on the Country List. Where a product purchased in one listed country and then used in another listed country:

- a) The international TEFAL/T-FAL guarantee duration is the one in the country of usage of the product, even if the product was purchased in another listed country with different guarantee duration.
- b) The international TEFAL/T-FAL guarantee does not apply in case of non conformity of the purchased product with the local standards, such as voltage, frequency, power plugs, or other local technical specifications
- c) The repair process for products purchased outside the country of use may require a longer time if the product is not locally sold by TEFAL/T-FAL
- d) In cases where the product is not repairable in the new country, the international TEFAL/T-FAL guarantee is limited to a replacement by a similar product or an alternative product at similar cost, where possible.

Consumer Statutory Rights

This international TEFAL/T-FAL guarantee does not affect the statutory rights a consumer may have or those rights that cannot be excluded or limited, nor rights against the retailer from which the consumer purchased the product. This guarantee gives a consumer specific legal rights, and the consumer may also have other legal rights which vary from State to State or Country to Country. The consumer may assert any such rights at his sole discretion.

Additional information

Accessories, Consumables and end-user replaceable parts can be purchased, if locally available, as described on the TEFAL / T-FAL internet site.

- * TEFAL household appliances appear under the T-FAL brand in some territories like America and Japan. TEFAL/T-FAL are registered trademarks of Groupe SEB





